

NINTENDO CLASSIC MINI



ENTERTAINMENT SYSTEM™



Operations Manual

Bedienungsanleitung • Mode d'emploi • Handleiding
Руководство пользователя • Manual de instrucciones
Manual de instruções • Manuale di istruzioni • Bruksanvisning
Betjeningsmanual • Käyttöopas • Brukerhåndbok

Nintendo of Europe GmbH
Herriotstraße 4
60528 Frankfurt am Main
Germany



MAA-CLV-A-CNES-EUR-CO



W99000006M

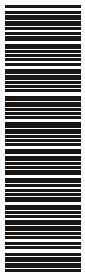

This seal is your assurance that Nintendo has reviewed this product and that it has met our standards for excellence in workmanship, reliability and entertainment value. Always look for this seal when buying games and accessories to ensure complete compatibility with your Nintendo Product.



Ce sceau est votre assurance que Nintendo a approuvé ce produit et qu'il est conforme aux normes d'excellence en matière de fabrication, de fiabilité et surtout, de qualité. Recherchez ce sceau lorsque vous achetez des jeux ou des accessoires pour assurer une totale compatibilité avec vos produits Nintendo.

Thank you for selecting the Nintendo Classic Mini: Nintendo Entertainment System™ console. • Merci d'avoir choisi la console Nintendo Classic Mini: Nintendo Entertainment System™.

Contents / Sommaire

English	4
Deutsch	XX
Français	XX
Nederlands	XX
Русский	XX
Español	XX
Português	XX
Italiano	XX
Svenska	XX
Dansk	XX
Suomi	XX
Norsk	XX

Contact Information / Kontaktinformation / Nous contacter / Contactgegevens / Контактные данные / Información de contacto / Informações de Contacto / Come contattarci / Kontaktinformation / Kontaktinformation / Yhteystiedot / Kontaktinformasjon	XX
------------------------------------------------------------------------------------------------------------------------------------------------------------------------------------------------------------------------------------------------------	----

Nintendo may change product specifications and update the manual from time to time. The latest version of the manual is available at <http://docs.nintendo-europe.com>. (This service may not be available in some countries.)

Nintendo kann von Zeit zu Zeit die Produktspezifikationen ändern und die Bedienungsanleitung aktualisieren. Die aktuellste Version dieser Bedienungsanleitung ist unter <http://docs.nintendo-europe.com> einzusehen. (Dieser Service steht in einigen Ländern möglicherweise nicht zur Verfügung.)

Nintendo est susceptible de changer les spécifications de ce produit et de mettre à jour son mode d'emploi à tout moment. Vous trouverez la version la plus récente du mode d'emploi à cette adresse : <http://docs.nintendo-europe.com/>. (Ce service n'est pas disponible dans tous les pays.)

Nintendo kan van tijd tot tijd productspecificaties wijzigen en de handleiding bijwerken. De meest recente versie van deze handleiding kun je vinden op <http://docs.nintendo-europe.com>. (Deze dienst is mogelijk niet in alle landen beschikbaar.)

Компания Nintendo может время от времени менять технические характеристики продукта и обновлять руководство. Актуальная версия руководства доступна на веб-сайте <http://docs.nintendo-europe.com>. (Этот сервис может быть недоступен в некоторых странах.)

Nintendo podría modificar las especificaciones del producto y actualizar el manual periódicamente. La versión más reciente del manual está disponible en <http://docs.nintendo-europe.com>. (Este servicio podría no estar disponible en algunos países.)

Tenha em consideração que a Nintendo poderá, ocasionalmente, alterar as especificações relativas ao produto e atualizar o manual. Por esse motivo, a Nintendo recomenda que consulte a última versão do manual referenciado em <http://docs.nintendo-europe.com>. Este serviço poderá não estar disponível em alguns países.

Nintendo può modificare le specifiche del prodotto e aggiornare periodicamente il manuale. La versione più recente del manuale è disponibile nel sito <http://docs.nintendo-europe.com> (in alcuni paesi questo servizio potrebbe non essere disponibile).

Nintendo kan komma att ändra produktspecifikationer och uppdatera bruksanvisningen då och då. Den senaste versionen av bruksanvisningen finns tillgänglig på www.nintendo.se/3ds/manual. (Den här tjänsten är eventuellt inte tillgänglig i vissa länder.)

Nintendo ændrer eventuelt produktspecifikationer og opdaterer manualen fra tid til anden. Den seneste version af denne manual er tilgængelig på www.nintendo.dk/3ds/manual. (Denne tjeneste kan være utilgængelig i visse lande.)

Nintendo voi silloin tällöin muuttaa tuotetietoja ja päivittää käyttöopasta. Käyttöoppaan uusin versio on saatavilla osoitteesta www.nintendo.fi/nintendo-3ds/manual. (Tämä palvelu ei välttämättä ole käytettävissä kaikissa maissa.)

Nintendo kan komme til å endre produktspecificasjoner og oppdatere manualen fra tid til annen. Den nyeste versjonen av brukerhåndboken er tilgjengelig på www.nintendo.no/3ds/manual. (Denne tjenesten kan være utilgjengelig i enkelte land.)

Health and Safety Information

Please read and observe the health and safety information. Failure to do so could result in injury or damage. Adults should supervise the use of this product by children.

WARNING – SEIZURES

- Some people (about 1 in 4000) may have seizures or blackouts triggered by light flashes or patterns, and this may occur while they are watching TV or playing video games, even if they have never had a seizure before.
 - Anyone who has ever experienced seizures, loss of awareness or any other symptom linked to an epileptic condition should consult a doctor before playing video games.
 - Parents or legal guardians should monitor children when they play video games. Stop playing and consult a doctor if you or your child have any unusual symptoms, such as: **convulsions, eye or muscle twitching, loss of awareness, altered vision, involuntary movements, or disorientation.**
- **To reduce the likelihood of a seizure when playing video games, follow these precautions:**
1. Do not play if you are tired or need sleep.
 2. Play in a well-lit room.
 3. Take a break of 10 to 15 minutes every hour.

WARNING – EYE STRAIN AND MOTION SICKNESS

Playing video games can make your eyes hurt after a sustained period of time. Playing video games can also cause motion sickness in some players. Follow these instructions to avoid eye strain, dizziness or nausea:

- Avoid excessively long play sessions. Parents or legal guardians should monitor their children for appropriate play.
- Take a break of 10 to 15 minutes every hour, even if you don't think you need it.
- If your eyes become tired or sore while playing, or if you feel dizzy, nauseated or tired, stop and rest for several hours before playing again.
- If you continue to have any of the above symptoms or other discomfort during or after play, stop playing and see a doctor.

WARNING – REPETITIVE MOTION INJURIES

Playing video games can make your muscles, joints or skin hurt after a few hours. Follow these instructions to avoid problems such as tendonitis, carpal tunnel syndrome or skin irritation:

- Avoid excessively long play sessions. Parents or legal guardians should monitor their children for appropriate play.
- Take a break of 10 to 15 minutes every hour, even if you don't think you need it.
- If your hands, wrists, or arms become tired or sore while playing, or if you feel symptoms such as **tingling, numbness, burning or stiffness**, stop and rest them for several hours before playing again.
- If you continue to have any of the above symptoms or other discomfort during or after play, stop playing and see a doctor.

WARNING – ELECTRICAL SAFETY

To avoid risk of overheating, fire, battery leakage, explosion, electric shock, injury, deformation and/or malfunction:

- Do not use the console during a lightning storm.
- Do not disassemble, make alterations to, or try to repair the console.
- Do not step on, forcefully bend or pull on the cables of the console. When unplugging the console from the AC adapter, turn off the console first and pull on the plug rather than the cable.
- Do not allow liquids or foreign substances to enter the console. In the event liquid (e.g. water, juice, oil or pet urine) or foreign substances enter the console, immediately stop using it, turn the power off, disconnect the AC adapter and contact Nintendo Customer Support for advice on how to proceed.
- Only use AC adapters that are compatible with this console.
- You can connect the USB power supply cable to an AC adapter with a USB port.
Note: You will need a 5V/900mA/4.5W output AC adapter. Please make sure to use an AC adapter that has been approved for use in your country. Please read the instruction manual for the AC adapter you wish to use to ensure that it is able to supply power to this console, and please use as instructed.
- When connecting the USB cable to the console or to an AC adapter, make sure the connector on the USB cable is oriented correctly and then insert it straight into the USB port.
- Do not touch connector terminals with your fingers or metal objects.
- Do not touch the console with wet, sweaty or oily hands.
- Do not use voltage transformers intended for use in other countries, or incandescent-specific light dimmers because it may change the power voltage.
- Do not overload the circuit by connecting an excessive amount of equipment to plug sockets or wiring accessories (e.g. connecting a series of multi-plug adapters).
- If you hear a strange noise, see smoke, or smell something strange when using the console, immediately turn off the power, disconnect the console from the AC adapter, and contact Nintendo Customer Support.

WARNING – GENERAL

- **Not suitable for young children – strangulation hazard. The cord of the controller can coil around the neck. Do not place the console or its accessories within reach of young children or pets.**
Children may place the cables or other accessories into their mouths and cause injury. Please immediately dispose of any unwanted packaging after removing the products. Small children may accidentally swallow packing materials.

Use your console carefully

- **Do not use or store the console in a high temperature or humid environment, such as:**
 - Areas exposed to direct sunlight
 - Near a heat source, such as a stove or heater
 - On top of a thermal or deep-piled carpet
 - On top of audiovisual equipment
 - Areas without ventilation, such as in a vehicle during the summer
- **Do not use or store the console in places with high levels of dust, fumes or tobacco smoke. If dust or other foreign material forms on the terminals or connectors of the console or cables, remove it using a vacuum cleaner, dry cloth or other appropriate product.**
- **Do not use or place the console in places where the temperature can suddenly change and cause condensation, such as in front of air conditioning units. If condensation forms, turn the console off and wait until the water droplets have evaporated.**
- **The console is for indoor use only.**
- **Do not expose the console to severe physical shock.**
- **Do not use excessive force when connecting cables or other accessories.**
- **Do not place magnetic items close to the console.**
- **Only use compatible accessories.**
- **Do not disassemble or try to repair the console.**
- **If the console is damaged, please contact Nintendo Customer Support. Do not touch damaged areas. Avoid contact with any leaking fluid.**

Using this Console

Getting Started

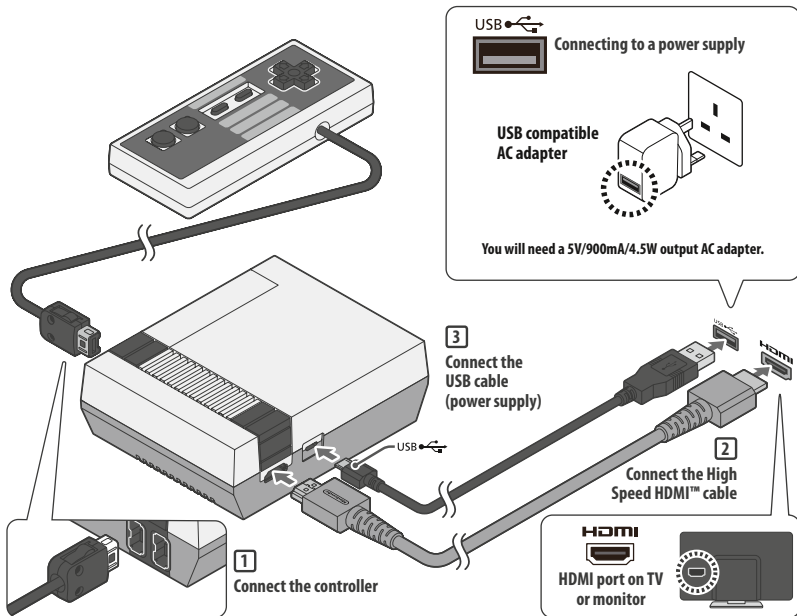

WARNING Make sure the connectors on the cables are oriented correctly and then insert them straight into the correct ports.

4 Turn the console on
The HOME Menu will be displayed. Please follow the on-screen instructions.



After Playing

In order to avoid malfunction or loss of data, please first turn the console off and then disconnect the AC adapter from the socket.

Power-Saving Mode

The console will automatically switch off after one hour with no input (a suspend point will be created if a game is running). This means that the console will be switched off but the POWER button will still be in the "on" position. The next time you use the console, you will have to set the POWER button to the "off" position and then return it to the "on" position to turn the power on.

StarTropics hint: The frequency revealed in the letter from Dr. J is 747MHz.

Contact Information

Warranty UK and Ireland

[180416/UKV-HW]

12-MONTH MANUFACTURER'S WARRANTY – NINTENDO HARDWARE

This warranty covers Nintendo consoles, including the original built-in software included with the respective Nintendo consoles at the time of purchase (the "Nintendo Operating Software") and any controllers included within the console packaging (the "Nintendo Controllers"). In this warranty, the Nintendo console, the Nintendo Operating Software and the Nintendo Controllers are referred to together as the "Product".

Subject to the terms and exclusions below, Nintendo of Europe GmbH, Herriotstr. 4, 60528 Frankfurt, Germany ("Nintendo") warrants to the original consumer purchasing the Product in any country of the European Economic Area or Switzerland ("you") that, for a period of 12 months from the date of the purchase of the Product by you, the Product will be free from defects in materials and workmanship.

EXCLUSIONS

This warranty does not cover:

- software (other than the Nintendo Operating Software) or games (whether included with the Product at the time of purchase or not);
- accessories, peripherals or other items that are intended for use with the Product but are not manufactured by or for Nintendo (whether included with the Product at the time of purchase or not);
- the Product if it has been resold, or used for rental or commercial purposes;
- defects in the Product that are caused by accidental damage, your and/or any third party's negligence, unreasonable use, modification, use with products not supplied, licensed or authorised for use with the Product by Nintendo (including, but not limited to, non-licensed game enhancements, copier devices, adapters, power supplies or non-licensed accessories), computer viruses or connecting to the internet or other forms of electronic communication, use of the Product otherwise than in accordance with the respective instructions, or any other cause unrelated to defects in material and workmanship;
- defects in the Product that are caused by the use of faulty, damaged or leaking batteries or battery packs, or any other use of batteries or battery packs not in accordance with the respective instructions;
- gradual decrease over time in the capacity and performance of batteries and battery packs for the Product (which, for the avoidance of doubt, will not be deemed to be a defect in material or workmanship of the Product);
- the Product if it has been opened, modified or repaired by any person or company other than Nintendo or its authorised partners, or if the Product has its serial number altered, defaced or removed;
- loss of any data that has been loaded onto or stored on the Product by any person or company other than Nintendo or its authorised partners;
- loss of data or any other content, such as software, as a result of formatting the memory of the Product (or the SD card/microSD card or any other external storage device being used with the Product); or
- loss of data or any other content as a result of deleting a Nintendo Network ID registered or linked to the Product.

HOW TO MAKE A CLAIM

To make a valid claim under this warranty, you must:

- notify Nintendo of the defect in the Product within 12 months of the date of the purchase of the Product by you, and
- return the Product to Nintendo within 30 days of notifying Nintendo of that defect.

To make a claim, please contact **Nintendo Customer Support**.

Before sending the Product to Nintendo Customer Support, you should remove or delete any private or confidential files or data.

By sending the Product to Nintendo you accept and agree that Nintendo will not be responsible for any loss, deletion or corruption of your files or data that has not been deleted or removed. Nintendo strongly recommends that you make a backup copy of any data that you do not remove or delete. Please note that, depending on the type of repair, data or other content stored in the memory of the Product may be deleted, and you may not be able to read data or other content saved to your SD card/microSD card or to any other external storage device, or import it back onto the Product following such repair.

When sending the Product to Nintendo Customer Support, please:

- use the original packaging where possible;
- provide a description of the defect;
- attach a copy of your proof of purchase, which indicates the date of purchase of the Product.

If, having inspected the Product, Nintendo accepts that the Product is defective, Nintendo will (at its sole discretion) either repair or replace the part causing the defect, or replace the relevant element of the Product without charge.

If the above 12-month warranty period has expired at the time the defect is notified to Nintendo or if the defect is not covered by this warranty, Nintendo may still be prepared to repair or replace the part causing the defect or replace the relevant element of the Product (at its sole discretion). For further information or, in particular, details of any charges for such services, please contact **Nintendo Customer Support**.

This manufacturer's warranty does not affect any statutory rights which you may have under consumer protection legislation as the purchaser of goods. The benefits described here are in addition to those rights.

Nintendo Customer Support (UK and Ireland)

[180416/UKV]

Nintendo Customer Support customer-support@nintendo.co.uk

www.nintendoservicecentre.co.uk (for support and repairs)
www.nintendo.co.uk (for general enquiries)

PO Box 4678, Windsor, SL4 9DZ
United Kingdom

(+44) 0345 60 50 247

(UK: Calls charged at the national rate. • Ireland: Calls charged at the international rate of the service provider.)

Nintendo Customer Support (South Africa)

[180416/BSA]

Nintendo Customer Support support@nintendo.co.za

www.nintendo.co.za

The iStore Building, No.1 Sandton Drive
Sandton, 2146
South Africa

(+27) 011 390 7002

(Calls are charged at the local rate to the caller.)

Kontaktinformationen

Gewährleistung Deutschland, Österreich, Schweiz, Belgien, Luxemburg

[280416/GER-HW]

12-MONATIGE HERSTELLERGEWÄHRLEISTUNG – NINTENDO-HARDWARE

Diese Herstellergewährleistung umfasst Nintendo-Systeme, einschließlich der auf dem jeweiligen Nintendo-System zum Zeitpunkt des Kaufs aufgestellten Original-Software (die „Nintendo-Systemsoftware“) und der zum Zeitpunkt des Kaufs in der Verpackung des Nintendo-Systems mitgelieferten Fernbedienungen (die „Nintendo-Fernbedienungen“). Für die Zwecke dieser Herstellergewährleistung werden das jeweilige Nintendo-System, die Nintendo-Systemsoftware und die Nintendo-Fernbedienungen zusammen als das „Produkt“ bezeichnet.

Nintendo of Europe GmbH, Herriotstr. 4, 60528 Frankfurt, Deutschland („Nintendo“) gewährleistet dem Erstkäufer des Produkts in einem Land des Europäischen Wirtschaftsraums oder in der Schweiz („Sie“/„Ihnen“) nach Maßgabe der folgenden Bedingungen für die Dauer von 12 Monaten ab dem Kaufdatum die Freiheit des Produkts von Material- und Verarbeitungsfehlern.

GEWÄHRLEISTUNGS AUSSCHLUSS

Diese Herstellergewährleistung umfasst nicht:

- Software (ausgenommen die Nintendo-Systemsoftware) oder Spiele (jeweils unabhängig davon, ob das Spiel oder die Software zum Zeitpunkt des Kaufs im Produkt inbegriffen war oder nicht);
- Zubehör, Peripheriegeräte oder andere Artikel, die zum Gebrauch mit dem Produkt bestimmt sind, aber nicht von oder für Nintendo hergestellt werden (unabhängig davon, ob diese Artikel zum Zeitpunkt des Kaufs dem Produkt beigelegt waren oder nicht);
- Produkte, die weiterverkauft oder für Miet- oder andere wirtschaftliche Zwecke benutzt wurden;
- Fehler des Produkts, die verursacht wurden durch Unfallschäden, Ihre eigene Fahrlässigkeit und/oder die Fahrlässigkeit eines Dritten, unsachgemäßen Gebrauch, Veränderungen, Gebrauch im Zusammenhang mit Produkten, die nicht von Nintendo geliefert, lizenziert oder für den Gebrauch mit dem Produkt autorisiert wurden (einschließlich z. B. nicht lizenzierter Spielerweiterungen, Kopieraufwerke, Anschlüsse, Netzteile oder nicht lizenzierten Zubehörs), Computerviren, Internet-Verbindungen oder andere Formen der elektronischen Kommunikation, Gebrauch, der nicht den jeweiligen Anleitungen entspricht, sowie durch jeden anderen Grund, der kein Material- oder Verarbeitungsfehler ist;
- Fehler des Produkts, die verursacht werden durch die Verwendung von mangelhaften, schadhafte oder undichten Batterien oder Batteriepacks, oder durch die Nutzung von Batterien oder Batteriepacks, die nicht den jeweiligen Anleitungen entsprechen;
- eine sich im Laufe der Zeit allmählich einstellende Abnahme der Leistung von Batterien und Batteriepacks für das Produkt (dies ist weder ein Mangel am Material noch ein Verarbeitungsfehler);
- Produkte, die durch andere Personen oder Unternehmen als Nintendo oder deren autorisierte Partner geöffnet, verändert oder repariert wurden oder deren Seriennummer geändert, entstellt oder entfernt wurde;
- den Verlust von Daten, die durch andere Personen oder Unternehmen als Nintendo oder deren autorisierte Partner auf das Produkt geladen oder auf diesem gespeichert wurden; oder
- den Verlust von Daten oder anderen Inhalten, wie zum Beispiel Software, infolge der Formatierung des Produkts (oder der SD Card/microSD Card bzw. anderer externer Speichermedien, die mit dem Produkt genutzt werden) durch Sie oder durch andere Personen oder Unternehmen als Nintendo oder deren autorisierte Partner; oder
- den Verlust von Daten oder jedweder anderer Inhalte durch Löschung der Nintendo Network ID, auf die das Produkt registriert oder mit der das Produkt verknüpft ist.

Disposal of this Product at the End of its Life

[220115/UKV/WEEE-1]

The crossed-out wheeled bin symbol means that this product should not be disposed of in your general household waste. Waste electrical and electronic equipment may contain hazardous substances which, if not treated properly, could lead to damage to the environment and human health. Instead, please contact your local authority for information on suitable collection sites and recycling facilities, or contact your local retailer who, in exchange for your buying an equivalent new product, may take back this product for free for recycling. This way you will be helping to ensure that the equipment is properly treated and its parts recovered, recycled or reused in an environmentally friendly way.



Entsorgen des Produkts

[220115/GER/WEEE-1]

Das Symbol der durchgestrichenen Mülltonne weist darauf hin, dass dieses Produkt nicht im normalen Hausmüll entsorgt werden darf. Elektro- und Elektronik-Altgeräte können gefährliche Substanzen enthalten, die, sofern sie nicht sachgemäß behandelt werden, schädlich für die Umwelt und die menschliche Gesundheit sein können. Um weitere Informationen über die jeweiligen Rücknahme- und Recyclingstellen in Ihrer Nähe zu erhalten, kontaktieren Sie bitte die zuständige Behörde oder wenden Sie sich an Ihren ortsansässigen Händler, um zu erfahren, ob dieser sich, im Falle dass Sie ein gleichwertiges Produkt kaufen, unentgeltlich um die sachgerechte Wiederverwertung kümmert. Auf diese Weise helfen Sie sicherzustellen, dass dieses Produkt ordnungsgemäß entsorgt wird und seine Bestandteile umweltverträglich wiedhergestellt, wiederverwertet oder wiederverwendet werden.



Jeter ce produit

[220115/FRA/WEEE-1]

Le pictogramme figurant une poubelle barrée signifie que ce produit ne doit pas être jeté avec les ordures ménagères. Les déchets d'équipements électriques et électroniques peuvent contenir des substances dangereuses qui, si elles ne sont pas traitées de manière appropriée, peuvent nuire à l'environnement et à la santé. Contactez les autorités locales pour obtenir des informations sur les services de collecte et de recyclage, ou demandez à votre revendeur s'il reprend gratuitement ce produit pour le recycler lorsque vous achetez un produit neuf équivalent. Ce produit pourra ainsi être traité de manière adéquate et ses composants récupérés, recyclés et réutilisés dans le respect de l'environnement.



Verwerking van dit product aan het eind van zijn levenscyclus

[220115/HOL/WEEE-1]

Het symbool van een doorgekruiste container geeft aan dat dit product niet samen met het huisvuil moet worden weggegooid. Afval van elektrische en elektronische apparaten kan gevaarlijke stoffen bevatten. Als deze niet op de juiste manier worden verwerkt, kunnen deze schadelijk zijn voor het milieu en de menselijke gezondheid. Neem in plaats daarvan contact op met de plaatselijke autoriteiten voor informatie over inzamel- en recyclingmogelijkheden, of met je plaatselijke Nintendo-winkelier, die dit product mogelijk gratis terugneemt om het te laten recyclen wanneer je er voortgelijk nieuw product koopt. Op die manier help je ervoor te zorgen dat de apparatuur op de juiste wijze wordt behandeld en de onderdelen ervan op een milieuvriendelijke wijze verzameld, gerecycled of hergebruikt worden.



Утилизация изделия по окончании срока службы

[220115/RUS/WEEE-1]

Символ перечеркнутого мусорного контейнера означает, что по окончании срока службы данное изделие нельзя выбрасывать вместе с обычными бытовыми отходами. Выбрасываемое электрическое и электронное оборудование может содержать опасные вещества, которые, в случае неправильной переработки, могут нести угрозу для окружающей среды и здоровья человека. За подробной информацией о подходящих местах приема и утилизации отслужившего оборудования обратитесь в местные органы власти. Также можно обратиться к местным продавцам, которые могут бесплатно принять это изделие для утилизации, если вы приобретете новое соответствующее изделие. Таким образом вы можете обеспечить надлежащую утилизацию оборудования и экологически безопасное восстановление, переработку или повторное использование его компонентов.



Cómo desechar este producto al final de su vida útil

[220115/ESP/WEEE-1]

El símbolo del cubo de basura tachado significa que este producto no debe ser arrojado a la basura doméstica. Los aparatos eléctricos y electrónicos podrían contener sustancias peligrosas que, de no ser procesadas adecuadamente, podrían contaminar el medioambiente o convertirse en un riesgo para la salud. Para obtener información acerca de los puntos de recogida y centros de reciclaje disponibles en tu lugar de residencia, ponte en contacto con las autoridades locales o consulta en tu tienda habitual (por la compra de un producto equivalente, podrían ofrecerse a hacerse cargo gratuitamente del reciclaje de este producto). De esta manera, contribuirás a que los aparatos sean tratados debidamente y a que sus componentes sean recuperados, reciclados o reutilizados de un modo respetuoso con el medioambiente.



Eliminação Deste Produto no Final da Sua Vida Útil

[220115/POR/WEEE-1]

O símbolo do caixote do lixo sobre rodas cortado por uma cruz indica que este produto não deve ser eliminado juntamente com o lixo doméstico. Os resíduos constituídos por equipamento elétrico e eletrónico podem conter substâncias perigosas que, se não forem tratadas corretamente, poderão ser prejudiciais ao ambiente e à saúde humana. Em vez disso, contacte a sua autoridade municipal para obter informações relativas a locais de recolha de resíduos para reciclagem na sua área de residência ou confirme junto do seu revendedor local se, na compra de um novo produto equivalente, este pode receber gratuitamente o produto atual e encaminhá-lo para reciclagem. Desta forma, estará a contribuir para que o equipamento seja devidamente eliminado e os seus componentes recuperados, reciclados ou reaproveitados de forma ambientalmente sustentável.



Come smaltire questo prodotto alla fine del suo ciclo di vita

[220115/ITA/WEEE-1]

Il simbolo barrato del contenitore mobile per la spazzatura significa che questo prodotto non deve essere smaltito insieme ai rifiuti domestici. I rifiuti di apparecchiature elettriche ed elettroniche possono contenere sostanze pericolose che, in caso di smaltimento non adeguato, possono avere effetti dannosi sull'ambiente e sulla salute. Contattare l'autorità municipale locale per informazioni sui siti di raccolta e sui centri per il riciclaggio, oppure rivolgersi al proprio rivenditore di fiducia che, in cambio di un acquisto equivalente, potrebbe incaricarsi gratuitamente del riciclaggio del prodotto. In questo modo si potrà collaborare a smaltire queste apparecchiature in modo adeguato e a recuperare, riciclare e riutilizzare tutti i loro componenti in modo inoffensivo per l'ambiente.



Kassering av den här produkten i slutet av dess livslängd

[230115/SWE/WEEE-1]

Den överkorsade symbolen med en soptunna betyder att den här produkten inte bör kasseras i ditt vanliga hushållsavfall. Elektrisk och elektronisk avfall kan innehålla farliga ämnen som, om de inte hanteras på rätt sätt, kan vara skadliga för miljön och människors hälsa. Kontakta istället dina lokala myndigheter för information om lämpliga insamlingsplatser och återvinningsstationer, eller kontakta din lokala återförsäljare som, i utbyte mot att du köper en ny produkt av samma värde, kan ta tillbaka den här produkten kostnadsfritt för återvinning. På så sätt hjälper du till att försäkra att utrustningen hanteras på rätt sätt och att dess delar återvinns eller återanvänds på ett miljövänligt sätt.



Bortskaffelse af produktet ved dets levetids ophør

[230115/DAN/WEEE-1]

Symbolet med affaldsbeholderen med kryds over betyder, at du ikke bør smide dette produkt ud sammen med det almindelige husholdningsaffald. Elektrisk og elektronisk affald kan indeholde farlige substanser, som, hvis de ikke håndteres korrekt, kan føre til skader på miljøet og menneskers helbred. I stedet skal du kontakte de lokale myndigheder for at få oplysninger om passende indsamlings- og genbrugsfaciliteter i nærheden af dig. Du kan også kontakte din lokale forhandler, der måske vil påtage sig den korrekte bortskaffelse, hvis du køber et nyt produkt af samme størrelse. På den måde kan du være med til at sikre, at udstyret behandles ordentligt og at komponenterne indsamles, genvindes og genbruges på en miljøvenlig måde.



Tämän tuotteen hävittäminen käyttöiän lopussa

[230115/FIN/WEEE-1]

Symboli, jossa on rasti pyörällisen jäteastian päällä, tarkoittaa, että tätä tuotetta ei saa hävittää tavallisen kotitalousjätteen mukana. Sähkö- ja elektroniikkalaiteromussa voi olla vaarallisia aineita, jotka voivat vahingoittaa ympäristöä ja ihmisten terveyttä, jos niitä ei käsitellä oikein. Kysy sen sijaan paikallisviranomaiselta lisätietoja sopivista keräys- ja kierrätyspisteistä tai ota yhteyttä paikalliseen jälleenmyyjään, joka voi ottaa tämän tuotteen vastaan maksutta, kun otostat vastaavan uuden tuotteen. Näin autat varmistamaan, että laite käsitellään oikein ja että sen osat otetaan talteen, kierrätetään tai käytetään uudelleen ympäristöystävällisellä tavalla.



Avhending av dette produktet etter levetidens slutt

[230115/NOR/WEEE-1]

Symbolet med den overkryssede papirkurven betyr at dette produktet ikke må avhendes sammen med vanlig husholdningsavfall. Elektrisk og elektronisk avfall kan inneholde farlige stoffer, som kan være miljø- og helseskadelige hvis de ikke håndteres riktig. Kontakt i stedet dine lokale myndigheter for informasjon om hvilke tjenester for innsamling og resirkulering av elektrisk og elektronisk avfall som finnes der du bor, eller kontakt din lokale forhandler, som kanskje tar imot dette produktet til kostnadsfri resirkulering hvis man kjøper et tilsvarende produkt. Slik bidrar du til at produktet blir behandlet på forsvarlig vis, og at komponentene blir gjenrunnet, resirkulert eller gjenbrukt på en miljøvennlig måte.



HDMI™ HIGH-DEFINITION MULTIMEDIA INTERFACE The terms HDMI and HDMI High-Definition Multimedia Interface, and the HDMI Logo are trademarks or registered trademarks of HDMI Licensing LLC in the United States and other countries. / Les termes HDMI et HDMI High Definition Multimedia Interface sont des marques commerciales ou déposées de HDMI Licensing LLC, aux États-Unis et/ou dans d'autres pays.

